

PS-6360 6 Volt 36.0 AH

Rechargeable Sealed Lead Acid Battery



We've Got The Power.™



Features

- Absorbent Glass Mat (AGM) technology for superior performance
- Valve regulated, spill proof construction allows safe operation in any position
- Power/volume ratio yielding unrivaled energy density
- Rugged impact resistant ABS case and cover (UL94-HB)
- Approved for transport by air. D.O.T., I.A.T.A., F.A.A. and C.A.B. certified
- U.L. recognized under file number MH 20845

Terminals

(mm)

- F2 - Quick disconnect tabs, 0.250" x 0.032", mate with AMP. INC. FASTON "250"
- NB1 - tin plated brass posts with 5mm nut & bolt fasteners

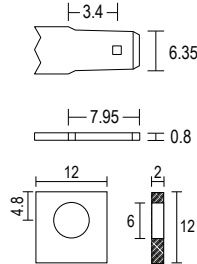

Physical Dimensions: in (mm)

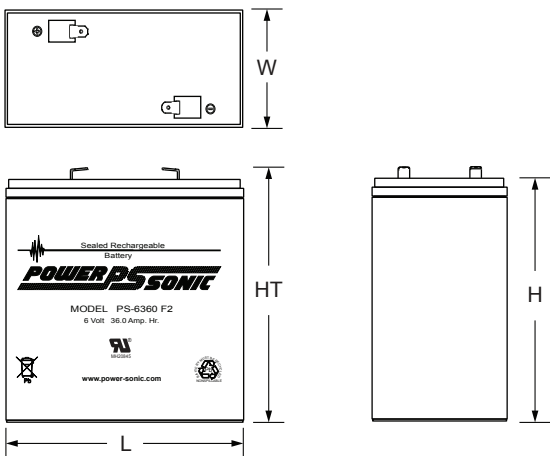

L: 6.25 (159) W: 3.35 (85) H: 6.50 (165) HT: 6.93 (176)

Tolerances are +/- 0.04 in. (+/- 1mm) and +/- 0.08 in. (+/- 2mm) for height dimensions. All data subject to change without notice.

Performance Specifications

Nominal Voltage	6 volts (3 cells)
Nominal Capacity	
20-hr. (1.8A to 5.25 volts)	36.00 AH
10-hr. (3.35A to 5.25 volts)	33.50 AH
5-hr. (6.12A to 5.10 volts)	30.60 AH
1-hr. (22.3A to 4.50 volts)	22.30 AH
15-min. (70.6A to 4.50 volts).....	17.65 AH
Approximate Weight	12.10 lbs. (5.49 kg)
Energy Density (20-hr. rate)	1.59 W-h/in ³ (96.85 W-h/l)
Specific Energy (20-hr. rate)	17.85 W-h/lb (39.36 W-h/kg)
Internal Resistance (approx.)	6 milliohms
Max Discharge Current (7 Min.)	108 amperes
Max Short-Duration Discharge Current (10 Sec.).....	360 amperes
Shelf Life (% of nominal capacity at 68°F (20°C))	
1 Month	97%
3 Months.....	91%
6 Months	83%
Operating Temperature Range	
Charge	-4°F (-20°C) to 122°F (50°C)
Discharge	-40°F (-40°C) to 140°F (60°C)
Case	ABS Plastic
Power-Sonic Chargers	PSC-64000A, 64000A-C

Shelf Life & Storage

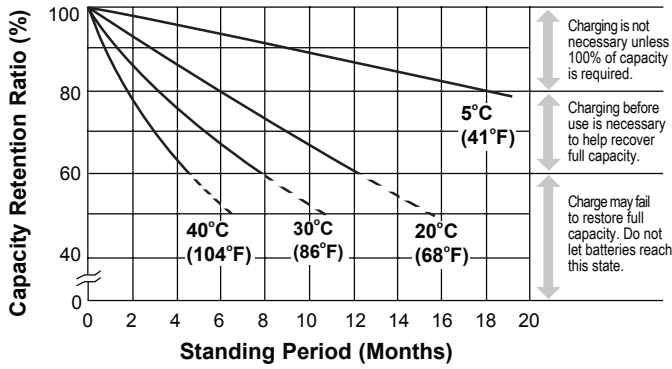

Discharge Characteristics

